

Quick Start Guide



 Don't leave the loupe half open



 When using the SpectraHD 4 with the EVF loupe, please take precaution to not leave the loupe half open. Leaving the loupe half open may result in your screen to burn from the sun.

SpectraHD 4

Electronic View Finder



- 1 Getting Started
- 2 Functions
- 3 Software Upgrade

What's in the box?



1 Getting Started

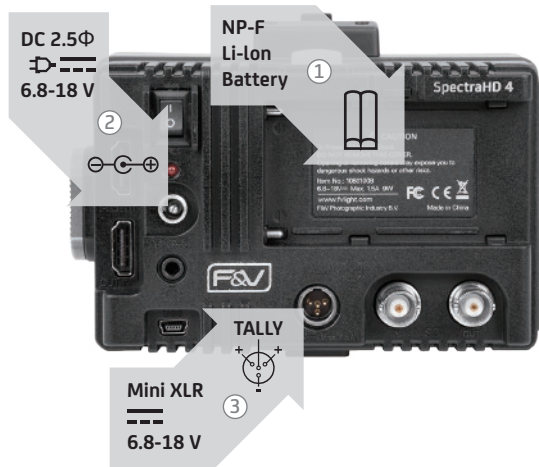

1 Power

Three power options

- NP-F li-ion battery (1)
- DC 2.5Φ 6.8-18V Max.1.5A (2)
- Mini XLR 6.8-18V Max.1.5A (3)

2 Signal

Input

- HDMI (1)
- SDI (2)

Output (Loop through)*

- HDMI (3)
- SDI (4)

*The signal can loop through, but it cannot cross-convert

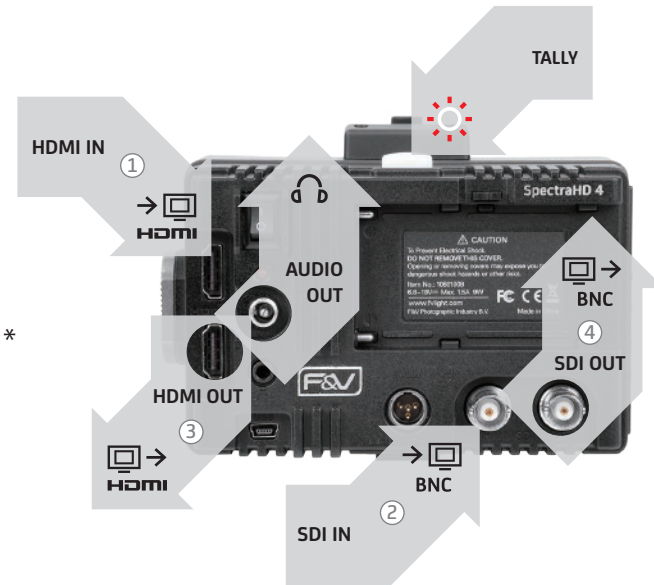

3 Let's do this!

Turn the monitor ON

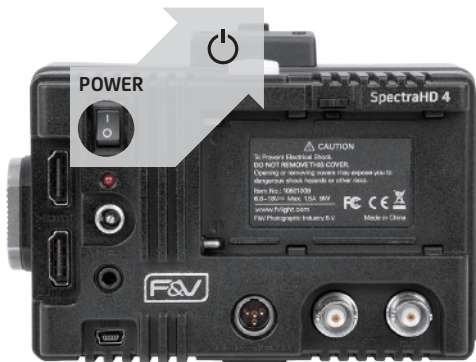

2 Functions

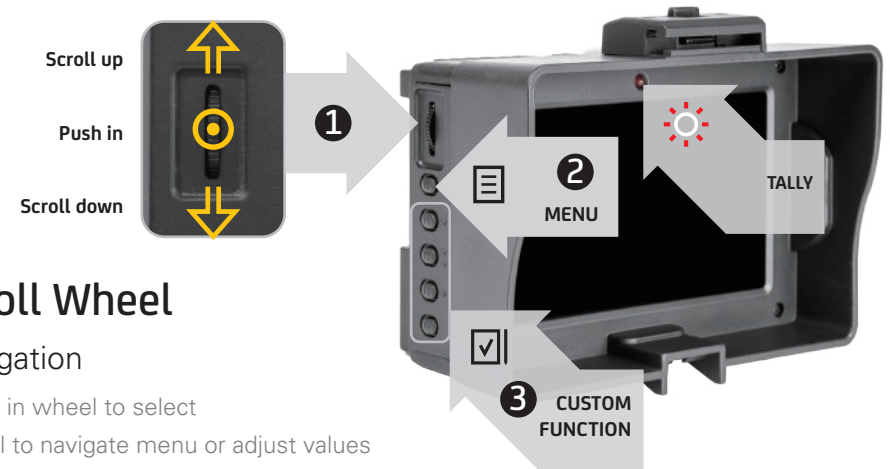

1 Scroll Wheel

Navigation

- Push in wheel to select
- Scroll to navigate menu or adjust values

Functions (When no menu is showing)

- Scroll up/down to quickly to adjust volume
- Push in to initiate shortcut to "Picture" settings. Continue to push in to cycle through all available "Picture" settings, such as brightness, contrast, etc. When a setting is displayed, scroll to adjust values

2 Menu / Back Button

When navigating the menu

- Click the menu button to "go back" in the menu navigation

3 Custom function button

Easily assign shortcuts to the function buttons in the "Advanced" menu screen

3 Software Upgrade



1 Download

Download the new firmware files to a USB stick (16GB or less)

2 Upgrade

- Turn the monitor off, and plug in USB
- Turn on monitor. The front buttons will begin to flash. Wait until buttons stop flashing and remain illuminated
- Turn OFF monitor, remove USB, and turn ON monitor